

# Indzawo Optic Connect

## At switch poe



### Overview

Midspan devices are power injectors that stand between a non-PoE Ethernet switch (or one that cannot provide sufficient power) and the powered device, injecting power without affecting the data. Overview Power over Ethernet (PoE) describes any of several or systems that pass along with data on cabling. This allows a single cable to provide both a data connection. There are several common techniques for transmitting power over Ethernet cabling, defined within the broader standard since 2003. The three t.



## At switch poe



What is a PoE switch (Power over Ethernet switch)?  
Power over Ethernet switch (or PoE switch) is an access layer technology that combines data signals and electrical power into a single ...



Midspan devices are power injectors that stand between a non-PoE Ethernet switch (or one that cannot provide sufficient power) and the powered device, injecting power without affecting the data.

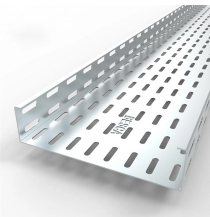

Compare 802.3af vs 802.3at PoE Standards and explore difference between 802.3af and 802.3at PoE+ including power delivery, voltage, use cases etc. as defined in Power Over Ethernet IEEE standards.



PoE is implemented as an integral power feature of the network switch, or via peripheral devices (referred to as midspans) that are installed between the switch and the network physical devices (PDs).



A Power over Ethernet switch is a network switch that has PoE functionality integrated. Learn about different variations, limitations and benefits of ...

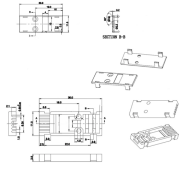

A PoE (Power over Ethernet) switch is a network switch that delivers both power and data through a single Ethernet cable to connected devices such as IP cameras, VoIP phones, wireless access ...



To calculate your PoE power requirement, sum the wattages of all devices, add a safety margin, and verify your switch can supply that total. Also, consider the maximum power per port.



This document describes the difference between PoE standards 802.3at and 802.3bt.



Learn key differences between PoE vs PoE+ vs PoE++. Compare power output, device compatibility, and use cases to find the best PoE switch for your needs.



A Power over Ethernet switch is a network switch that has PoE functionality integrated. Learn about different variations, limitations and benefits of PoE switches.



Confused about PoE? See how 802.3af vs 802.3at stack up, from power limits to real-world uses, and learn which standard is best for your devices.

## Contact Us

For more information, pricing, or custom solutions, please contact us:

Website: <https://indzawo.co.za>

Email: [sales@indzawo.co.za](mailto:sales@indzawo.co.za)

Phone: +27 71 296 8473

Address: 22 Quantum Street, Midrand, 1685, Gauteng, South Africa

This document is for informational purposes only. Specifications subject to change without notice.

