

# **Customization Process for Energy-Saving Quantum Communication MPO Connectors**



## Customization Process for Energy-Saving Quantum Communication



Using industry-standard MPO connectors and offering a range of fiber counts with single-mode and multi-mode options help ease system design challenges for a variety of applications.

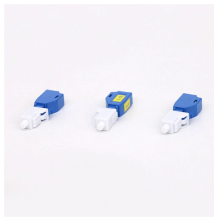

The high-density modular design fits into rack mount fiber cassette enclosures to ensure efficient use of space and rapid network deployment.



Learn how MTP®/MPO connectors power high-density 40G/100G/400G/800G networks, AI fabrics and leaf-spine designs, with design tips and multi-vendor guidance.

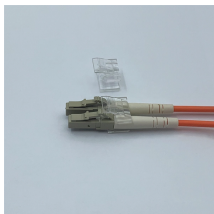

Explore MPO connector assembly solutions with MT Ferrule-specific fixturing, tools, and materials for high-density network cabling systems like data centers.



A reliable MPO order process usually follows a predictable sequence. First, the buyer confirms the functional role of the cable: trunk, patch cord, harness, or breakout assembly.



We manufacture these rugged mpo fiber cables with custom lengths and robust LSZH/OFNP flame-retardant jacketing to meet your most demanding project specifications.



The on-site customization facilitated by the Lynx-CustomFit™ connectivity method eliminates the risk of shorts and slack, repair lag, and logistic delays associated ...



Understanding the basis of MTP®/MPO patch cables, different MTP®/MPO cable types, and key applications is essential for designing a reliable and scalable MTP®/MPO cabling system.

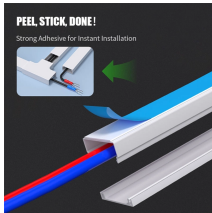

To meet these stringent demands, a new generation of connectors with ultra-low insertion loss, high return loss, and high-density capabilities is crucial for the advancement and reliability of quantum ...



While this concept might seem simple, it becomes more complex with multi-fiber MPO cables and connectors. Industry standard TIA-568.3-D names three different polarity methods for MPOs: Method ...

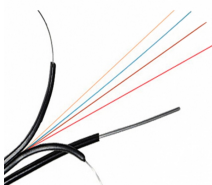

Unlike single-fiber connectors, which are all male, MPO connectors are either male (with alignment pins) or female (without alignment pins). In order to mate two MPO connectors together through an ...

## Contact Us

For more information, pricing, or custom solutions, please contact us:

Website: <https://indzawo.co.za>

Email: [sales@indzawo.co.za](mailto:sales@indzawo.co.za)

Phone: +27 71 296 8473

Address: 22 Quantum Street, Midrand, 1685, Gauteng, South Africa

This document is for informational purposes only. Specifications subject to change without notice.

