

# Dimensions of Aluminum Alloy Cable Trays for Oil Pipeline Monitoring



## Overview

This article breaks down cable tray dimensions in a clear, practical, and engineering-driven way. From an engineering standpoint, cable tray dimensions are not. Aluminum Cable Tray systems are lighter than steel cable tray and Certified CSA Cable Tray, UL listed, NEMA and certified. 316 Stainless Steel is also available (minimum quantities required). All trays are manufactured and tested in accordance with the latest NEMA and IEC 61537 Standards. The Aluminum Cable Ladder has a high.



## Dimensions of Aluminum Alloy Cable Trays for Oil Pipeline Monitoring



It provides specifications for various straight sections, fittings, and accessories of the cable tray system including side rails, rungs, splices, elbows, tees, brackets, and bonding jumpers.



Aluminum Cable Tray systems are lighter than steel cable tray and Certified CSA Cable Tray, UL listed, NEMA and certified. Because of their lighter weight aluminum cable trays are easier to install than ...



WESTRAYS are supplied in 2.44 meter or 3.0 meter or 3.66 meter standard lengths. The channel type trays are manufactured in various widths & heights of aluminum or hot dipped galvanized carbon ...



Made from aluminum alloy, these rugged components bolt together to form a solid and reliable cable pathway. To secure and protect your infrastructure cables, RXL offers high quality aluminum cable ...



All calculations and data are based on 42 in. wide cable trays with rungs spaced on 12 in. centers with tray supported as simple spans with deflection measured at the midpoint. Continuous spans may ...



The aluminium cable tray weighs approximately half as much as its steel equivalent. Aluminum cable trays do not rust and are highly durable, even in saltwater environments.



Explore standard sizes by tray type, understand width and depth limits, and see how to calculate and choose compliant cable tray sizes for real projects.



Available in various sizes and configurations, Harsha Group's aluminum cable trays are suitable for different cable routing needs. Material : Aluminum Alloy. Finish : Natural aluminum finish. Size : ...



Our cable tray design considerations guide details key factors to consider when designing cable tray systems for industrial and commercial applications. Browse or download the cable tray catalog for ...



TechLine Mfg perforated angle & channel cable trays from hot dipped galvanized, aluminum, & 304 SS finishes available. Contact us for a quote!

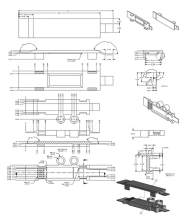

Explore standard sizes by tray type, understand width and depth limits, and see how to calculate and choose compliant cable tray sizes for real projects.

## Contact Us

For more information, pricing, or custom solutions, please contact us:

Website: <https://indzawo.co.za>

Email: [sales@indzawo.co.za](mailto:sales@indzawo.co.za)

Phone: +27 71 296 8473

Address: 22 Quantum Street, Midrand, 1685, Gauteng, South Africa

This document is for informational purposes only. Specifications subject to change without notice.

