

What is a distribution box RDJ



Overview

A distribution box, also known as a distribution panel or board, is a cabinet that holds electrical parts used to supply power to multiple circuits within a system. It acts as the central point where electricity distribution is managed inside a building. It integrates power distribution, protection, and monitoring capabilities, and is responsible for distributing power to entire commercial or residential. A distribution boxes is an essential device that manages the safe and efficient flow of electrical power throughout different areas of a building or facility.



What is a distribution box RDJ



What are Distribution Boxes and Their Importance?
What are Distribution Boxes and Their Importance?
Distribution boxes, or electrical junction boxes as they are sometimes called, play ...



A distribution box is a compact electrical enclosure designed to help safely manage local power distribution. It doesn't handle large-scale circuit management like a distribution board, but ...

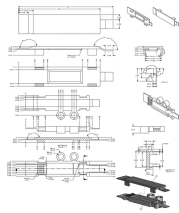

So, what is a distribution box? It organizes and controls power flow, ensuring safety and efficiency. By managing circuits individually, it prevents overloads and keeps your electrical setup ...

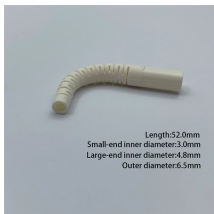



A distribution box, also known as a distribution board or panel, is the central unit that distributes incoming electrical power to various circuits. The primary role of a distribution box is to ...



In Conclusion Most residential and commercial electrical systems have at least one distribution box. A distribution box is a device that, as the name suggests, is designed to distribute ...

	<p>A distribution box, also known as a distribution panel or board, is a cabinet that holds electrical parts used to supply power to multiple circuits within a system.</p>
---	---

	<p>A distribution boxes acts as the load center and main distributor of electrical power within a building. Also called a distribution board, panel board, breaker panel, or electric panel, it is the ...</p>
---	--

	<p>What is a Distribution Box? A distribution box, or DB box, is a circuit breaker enclosure. It is a vital part and central hub of any electrical system. The hub distributes electrical power from a ...</p>
--	--

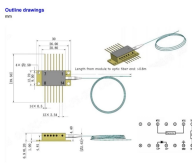
	<p>A distribution box, also known as a power distribution box or electrical distribution box, is used to distribute electrical power safely to multiple circuits. It helps organize, protect, and control ...</p>
---	---

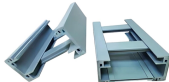
	<p>Electrical distribution boxes are used in commercial and residential buildings and are part of the electrical system, also known as switchboards. It integrates power distribution, protection, and ...</p>
---	--

	<p>A distribution box, also known as a distribution board or panel, is the central unit that distributes incoming electrical power to various circuits. The ...</p>
---	---

Contact Us

For more information, pricing, or custom solutions, please contact us:

Website: <https://indzawo.co.za>

Email: sales@indzawo.co.za

Phone: +27 71 296 8473

Address: 22 Quantum Street, Midrand, 1685, Gauteng, South Africa

This document is for informational purposes only. Specifications subject to change without notice.

