

## What is the box for connecting a network cable to a fiber optic cable called

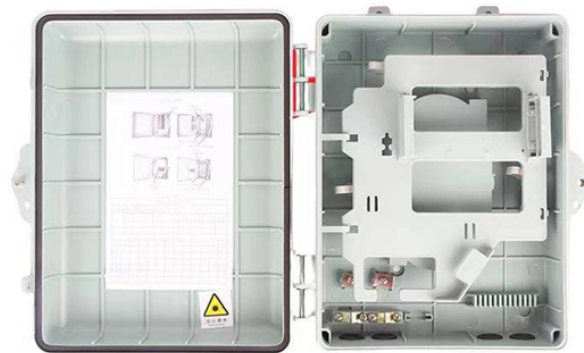

### Overview

A fiber optic distribution box, also known as a fiber optic terminal box or fiber optic termination box, is a device used to connect and manage fiber optic cables in a network. One essential component of a fiber optic network is the fiber optic distribution box. What is the difference between these fiber boxes.



## What is the box for connecting a network cable to a fiber optic cable



The fiber optic terminal box is the terminal connector of the fiber optic cable, one end is the fiber optic cable, and the other is the tail of the fiber optic cable.



A fiber termination box, often referred to as an optical distribution box or fiber distribution box, is a protective enclosure used to terminate and organize fiber optic cables.



The fiber optic termination box is an essential device in fiber optic networks, its stable performance and a variety of configuration options, can provide users with high-quality network ...



Fiber Termination Box, also known as FTB, typically consists of two main parts: the outer shell body and the adapter tray that protects the fiber connector points. It is a crucial component in ...

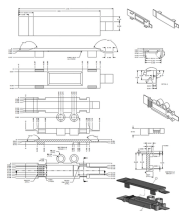

Fiber Termination Box, also known as FTB, typically consists of two main parts: the outer shell body and the adapter tray that protects the fiber connector points. It is a crucial component in ...



In network cabling, outdoor connections generally use fiber optic cables. When these optical fibers are installed or laid out, a Fiber Termination Box, or FTB, is used to distribute and ...



A fiber optic distribution box, also known as a fiber optic terminal box or fiber optic termination box, is a device used to connect and manage fiber optic cables in a network. It serves as ...

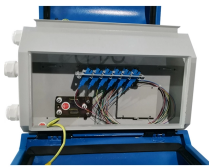

Fiber optic distribution box (FDB) is widely used in FTTH access network, Telecommunication network, CATV network, Data communication network and local area network ...



A fiber optic junction box, also known as a fiber optic distribution box or termination box, is a protective enclosure that facilitates the connection and management of fiber optic cables.



Optical Network Terminals (ONTs): Often called "fiber boxes," ONTs are located inside homes and connect the fiber optic cable to the internal network. They receive the optical signal from ...

## Contact Us

For more information, pricing, or custom solutions, please contact us:

Website: <https://indzawo.co.za>

Email: [sales@indzawo.co.za](mailto:sales@indzawo.co.za)

Phone: +27 71 296 8473

Address: 22 Quantum Street, Midrand, 1685, Gauteng, South Africa

This document is for informational purposes only. Specifications subject to change without notice.

