

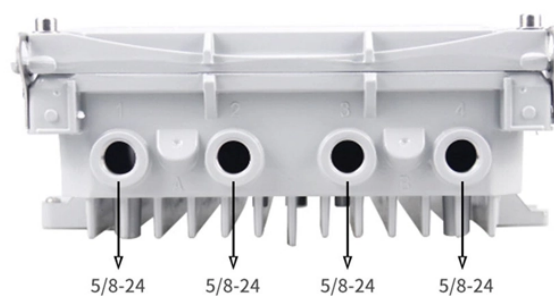

Where is the power button on the network server rack





Overview

After all connections are secure, press the power button on the front panel to initiate server startup. Observe the system status indicators. The server includes Integrated Lights-Out 6 (iLO 6) for remote management. Main power mode—Power is supplied to all server components and any operating system on your drives can run. How to physically install a server in a rack or tower mode is explained in PowerEdge: Rack Rail Types for Installation, Static Rails vs. Component Installation (Hard Drives and Memory) Hard drives and memory upgrades are included separately and require installation. **CAUTION:** A CAUTION indicates either potential damage to hardware or loss of data and tells you how to avoid the problem.

Where is the power button on the network server rack

<p>Waterproof and dustproof, reliable and safe</p> <p><small>The outer classic sink design allows the sealing ring of the cabinet and door to be seamlessly compressed without leaving a trace of gaps</small></p> 	<p>You can manually turn on or off the system by pressing the power button located on the power button control panel. For more information, see page 11 of the manual.</p>
--	--

	<p>Enables you to know the power status of the system. The power-on indicator glows when the system power is on. The power button controls the power supply output to the system.</p>
---	---

	<p>The power button is the small round one on the front plate next to the USB ports and LCD.</p>
--	--

	<p>To completely remove power, you must disconnect all power cords from the power supplies in the server, as directed in the service procedures. You can shut down the server by using ...</p>
---	--

	<p>Main power mode—Power is supplied to all server components and any operating system on your drives can run. Standby power mode—Power is supplied only to the service processor and ...</p>
---	---



Use this button only if directed to do so by qualified support personnel or by the operating system's documentation. The identification buttons on the front and back panels can be used to locate a ...



Comprehensive instruction manual for the HPE ProLiant DL380 Gen11 2U Rack Server, covering setup, operation, maintenance, troubleshooting, and specifications.



This button allows you to locate the specific server that you are servicing when you go to the opposite side of the rack. You can also activate these LEDs remotely by using the Cisco IMC ...

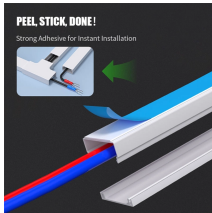

If the power button LED is not lighting up or is not flashing correctly, reseal all the power supplies and make sure the AC LEDs on the PSU rear side light up. If you have just installed an optional device, ...



This button allows you to locate the specific server that you are servicing when you go to the opposite side of the rack. You can also activate these LEDs remotely by using the Cisco IMC ...

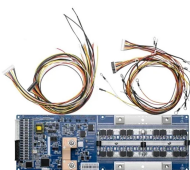

How to physically install a server in a rack or tower mode is explained in PowerEdge: Rack Rail Types for Installation, Static Rails vs. Sliding Rails. Connect the power and turn on the ...

Contact Us

For more information, pricing, or custom solutions, please contact us:

Website: <https://indzawo.co.za>

Email: sales@indzawo.co.za

Phone: +27 71 296 8473

Address: 22 Quantum Street, Midrand, 1685, Gauteng, South Africa

This document is for informational purposes only. Specifications subject to change without notice.

